



## BUILDING HIGHLIGHTS

- 8,592 rentable square feet of retail space on one level available
- Located between Chadwicks and Cycle Life on K Street, NW
- Open floor plan and 11'5" ceiling heights with double store fronts overlooking the new Georgetown Waterfront Park
- \$37.50 plus Taxes and Utilities
- Ideal for retail, service, office, or high-quality, non-vented food users
- Located in the heart of Georgetown, one block from the Ritz Carlton, Loew's Theatres, Hershey's Ice Cream, Bank of Georgetown, & Mate, halfway between Washington Harbour & the Georgetown Park Mall, and surrounded by Georgetown's 3 million square feet of office space
- Garage parking in the building and an abundance of metered street parking along K Street

**BILL MILLER**

202.775.7033

bill.miller@transwestern.net



## BUILDING HIGHLIGHTS

- 3,000 - 8,592 rentable square feet of office space on one level available
- Flexible lease terms available
- Located between Chadwicks and Cycle Life on K Street, NW
- Open floor plan and 11'5" ceiling heights with double store fronts overlooking the new Georgetown Waterfront Park
- Located in the heart of Georgetown, one block from the Ritz Carlton, Loew's Theatres, Hershey's Ice Cream, Bank of Georgetown, & Mate, halfway between Washington Harbour & the Georgetown Park Mall, and surrounded by Georgetown's 3 million square feet of office space
- Garage parking in the building and an abundance of metered street parking along K Street

**JEFF GROSS**  
202.775.7018  
jeff.gross@transwestern.net

**BILL MILLER**  
202.775.7033  
bill.miller@transwestern.net

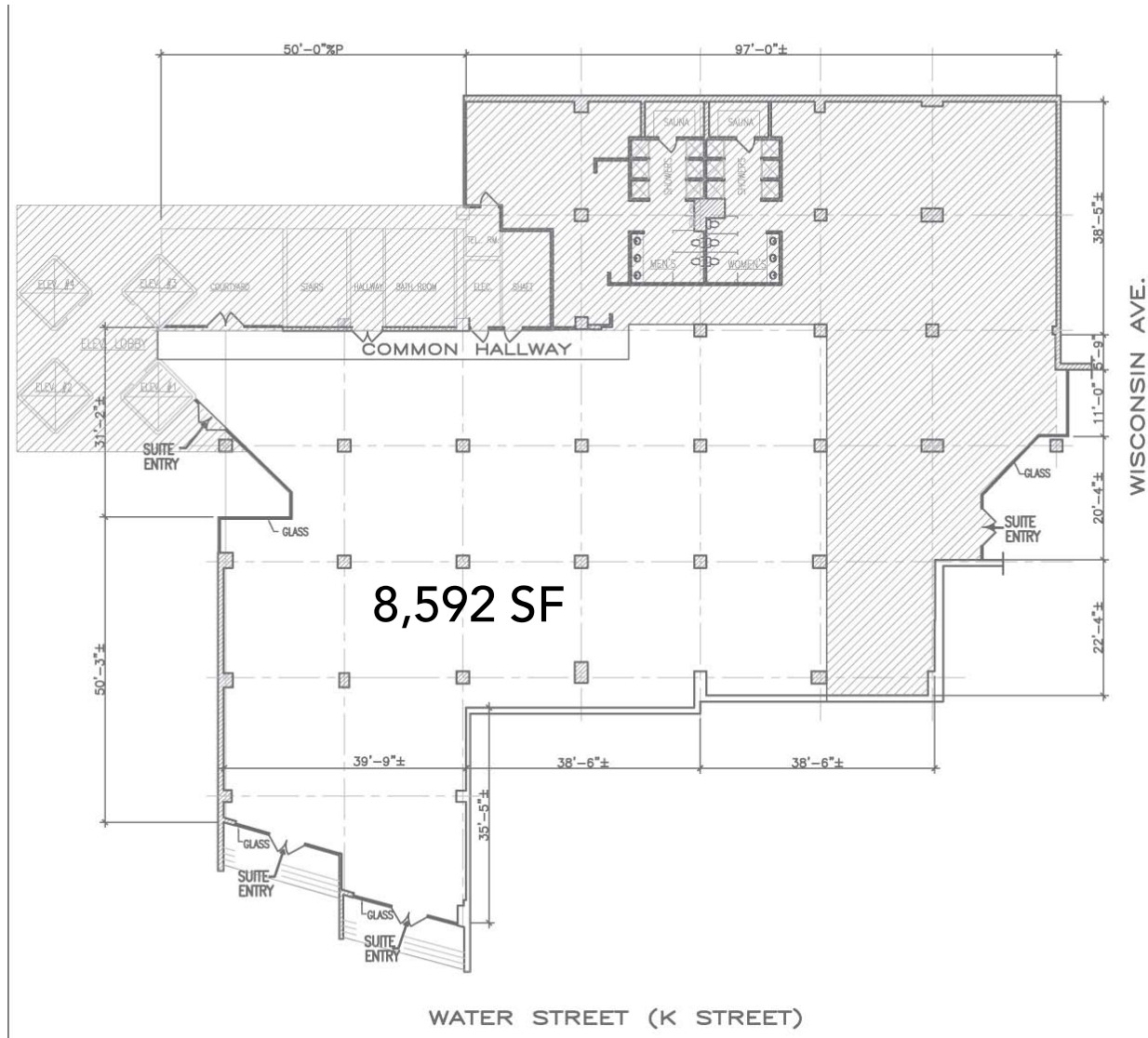

# 1010 Wisconsin Avenue, NW

Washington, DC

TRANSWESTERN  
**RETAIL**



1010 WISCONSIN AVENUE, NW  
Washington, DC

TRANSWESTERN  
**RETAIL**

